

Welch Allyn Technical Support

(www.welchallyn.com/support)

USA	+1 800 535 6663 +1 315 685 4560
Australia	+61 2 9638 3000
Canada	+1 800 561 8797
China	+86 21 6327 9631
European Call Center	+353 46 90 67790
France	+33 155 69 58 49
Germany	+49 695 098 5132
Italy	+39 026 968 2425
Japan	+81 42 703 6084
Latin America	+1 305 669 9003
Malaysia	+603 7884 3329
Netherlands	+31 202 061 360
Singapore	+65 6419 8100
South Africa	+27 11 777 7555
Spain	+34 917 499 357
Sweden	+46 85 853 6551
United Kingdom	+44 207 365 6780

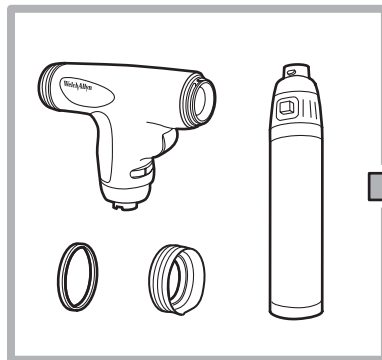

1

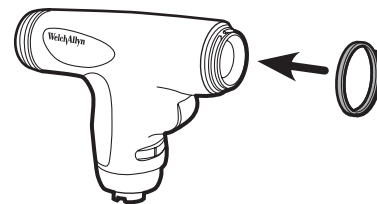

2

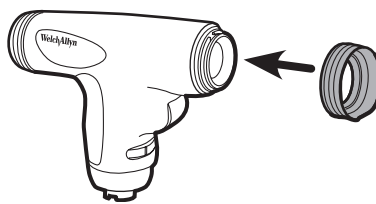

3

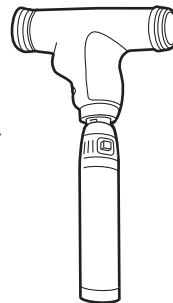
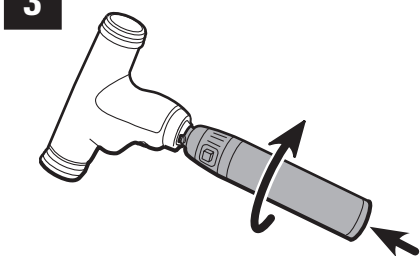

Manufacturer
Welch Allyn, Inc.
4341 State Street Road
Skaneateles Falls, NY 13153 USA
www.welchallyn.com

EC REP

Regulatory Affairs Representative, EU
Welch Allyn Limited
Navan Business Park
Dublin Road
Navan, County Meath
Republic of Ireland

To order, or for more information, please contact:

docStock
.com.au

Ph: (02) 8850 7177 Fax: (02) 8850 7988
email: info@docstock.com.au

www.docstock.com.au [...medical products online]



Consult PanOptic
Instructions for use

WelchAllyn®

iExaminer™ Assembly Instructions

REF 11840

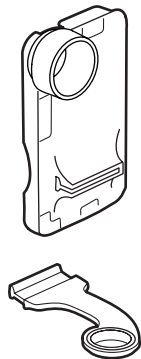

R_x ONLY

Mat. 718778, 80017721 Ver. B
© 2012 Welch Allyn, Inc.

**iExaminer
Assembly
Instructions**

REF 11840

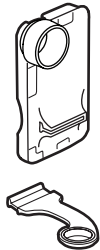

REF 11810 / 11820



1

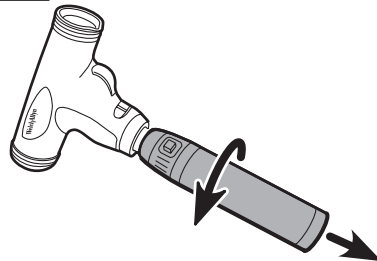

2

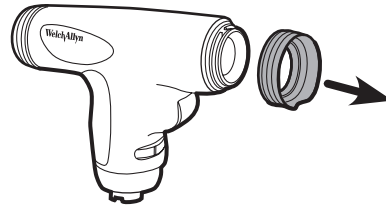

3

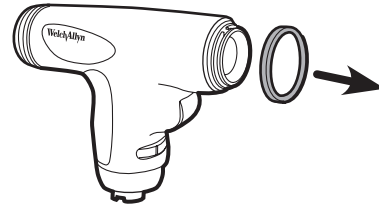

4

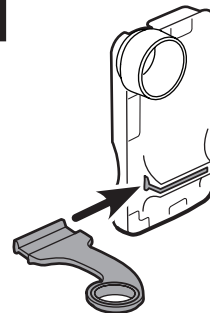

5

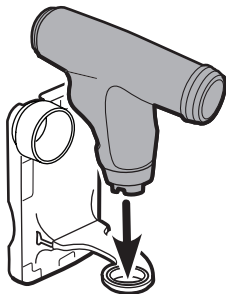

6

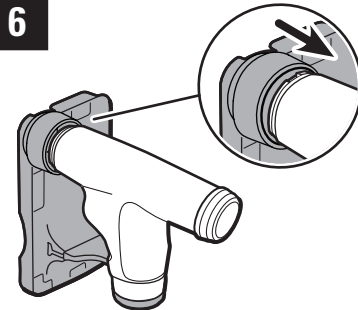

7

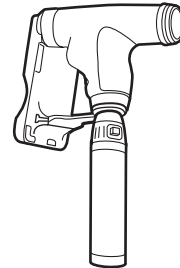
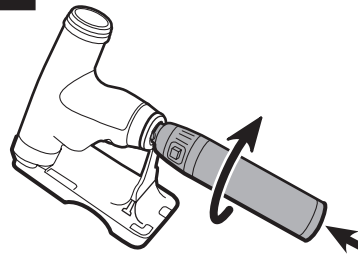

www.welchallyn.com/iExaminer